



NOVA 3

ROUND, DIRECT ILLUMINATION



SPECIFICATIONS

PROFILE	Round
SIZE	3.5" diameter
LED OUTPUT	500lm - 2,000lm
CCT/CRI	2700K/3000K/3500K/4000K • 90 CRI
DIMMING/ DRIVER	Canopy and Remote Driver: 0-10V, Phase, DALI, DMX, eldoLED, Lutron®, PoE (Molex, Igor, NuLEDs). Dimming to 0% for select models
POWER	3.7W to 15.8W per fixture
INPUT	100VAC or 277VAC Phase dimmable versions are 120VAC only
OPTICS	10° - 90° distribution optics, including reflectors, lenses, wall washes and square beam shaping optics. Field replaceable without tools.
FINISHES	Powder coat - TGIC polyester
MATERIAL	Extruded aluminum with galvanized steel hardware
ENVIRONMENT	Indoor dry or damp locations

WELL

For UGR values and recommended options that contribute to meeting the WELL Building Standard™ see [WELL addendum](#).

*Safety and Performance information available on last page. Output and other specifications available on page 8.

DISTRIBUTIONS & PROFILES

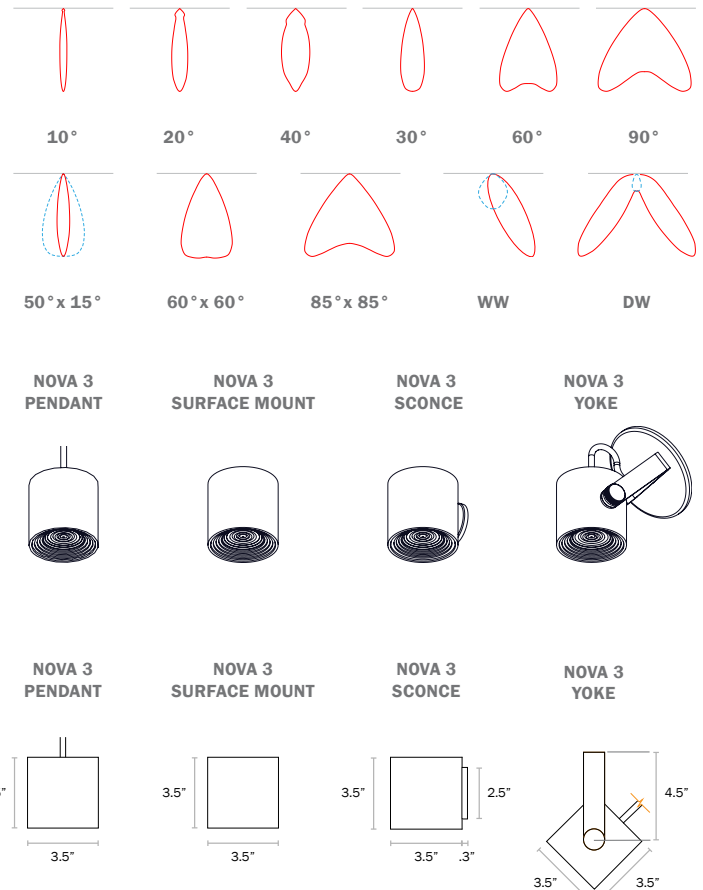

Not to scale. Dimensions are nominal. Consult factory for CAD drawing





PRODUCT SUBMITTAL QUICK WORKSHEET

1	2	3	4	5	6	7	8	9	10	11	12
---	---	---	---	---	---	---	---	---	----	----	----

EXAMPLE: NRP3 – 159027R2HL – DRDV00 – SWBK – NLT – EMB
1 2 3 4 5 6 7 8 9 10 11 12

1. MODEL (CHOOSE 1)	2. OUTPUT (CHOOSE 1)	3. CRI	4. CCT (CHOOSE 1)
NRP3 Pendant	05 ¹ 500lm	90 90	27 2700K
NRM3 Surface Mount	08 ² 800lm		30 3000K
NRS3 Sconce	10 1000lm		35 3500K
NRY3 Yoke	15 1500lm		40 4000K
	20 2000lm		
¹ Available for V01 dimming only. ² Available for V00, V01, P01, ELDOVO, DALI, and DMX dimming only.			

5. OPTICS* (CHOOSE 1)	6. OPTICAL ACCESSORY (CHOOSE 1)	7. DRIVER LOCATION* (CHOOSE 1)	8. DIMMING* (CHOOSE 1)
R1 10° Reflector R2 20° Reflector R4 40° Reflector L3 30° Lens L6 60° Lens L9 95° Lens S1 50°x 15° Oval Lens S2 60°x 60° Square Lens S3 85°x 85° Square Lens WW Wall Wash Lens DW Dual Wall Wash Lens GN ² Glow Narrow Beam GM ² Glow Medium Beam GW ² Glow Wide Beam GD ² Glow Solid Diffuser	NN None HL ³ Honeycomb Louver ³ Only available with R1, R2, and R4 optics	DIRECT TO SURFACE DRD ^{4,5} 2.5" Shallow Canopy, Remote Driver J-BOX MOUNTING JRD 5" Shallow Canopy, Remote Driver JDD ^{6,7} 5"- 7.5" Deep Canopy, Canopy Driver JRM ^{4,8} Mud Ring, Remote Driver ⁴ See 'Dimensions and Mounting' on page 3 to ensure correct driver location specification. ⁵ See 'Dimming/driver location compatibility' on page 8 to ensure correct dimming specification. ⁶ DRD and JRM Surface Mount do not include a canopy. ⁷ DRD is not available for Yoke. ⁸ JDD mounting only available with Pendant mounting. ⁹ JDD Deep Canopy diameter depends on LED driver. ¹⁰ JRM available for Surface Mount only. Mud ring provided by others.	V00 (0-10V, dim to 0%) V01 (0-10V, dim to 1%) P01 (ELV/TRIAC phase dim to 1%) ELDVO (eldoLED, 0-10V, dim to 0%) LDE1 (Lutron ECOSYS1, 0-10V, dim to 1%) DALI (DALI, dim to 0%) DMX (DMX, dim to 0%) POEM ⁹ (POE Molex) POE1 ⁹ (POE IGOR) POEN ⁹ (POE Nuleds) POE ^{9,10} (POE Ready) ⁹ See 'Driver', 'Sensor', and 'dimming/driver compatibility' charts for sensor and dimming compatibility. ¹⁰ Available for Remote driver only. ¹¹ Choose if desired PoE solution not listed. Contact customer service to review and confirm the PoE system of your choice.

* Beam angles noted above are nominal.
* See page 4 for glow optical options.
* Available for Pendant and Surface Mount only.

9. SHELL COLOR* (CHOOSE 1)	10. SUSPENSION* (CHOOSE 1)	11. SENSOR OPTIONS* (OPTIONAL CHOOSE 1)	12. EMERGENCY OPTIONS* (OPTIONAL)
STANDARD FINISHES SW <input type="checkbox"/> Satin White SB <input type="checkbox"/> Satin Black AS <input type="checkbox"/> Aluminum Silver Anodized Effect TB <input type="checkbox"/> Textured Black PREMIUM FINISHES --- See chart on page 5 for premium finishes. Manually type in the finish code (Ex: OB = Oil-Rubbed Bronze) SPECIAL ORDER FINISHES* RAL ____ Specify RAL Classic Color (Ex: RAL 3003) CCM ____ Custom Color Match	PENDANT STYLE BK ¹¹ Black Cord WH ¹¹ White Cord CB ¹¹ Clear Braided Cord CC ____ ^{11,12,13} Color Cord RS## ¹⁴ Rigid Stem SS## ¹⁴ Swivel Stem YOKE STYLE SC Standard Canopy RS## ¹⁴ Rigid Stem SS## ¹⁴ Swivel Stem ¹¹ Selection not required for Surface Mount and Sconce. ¹² Standard cord length 6ft. For longer cords, type desired length after cord style in product code above (i.e. BK/8 = Black Cord + 8ft cord length) ¹³ Available only with Deep or Remote Driver, 0-10V, ECOSYS1, DMX and DALI. Available with deep, remote, and internal driver for ELC/TRIAC phase dimming. ¹⁴ Type code for desired color into product code above (i.e. CC5/8 = Neon Coral cord + 8ft length) ¹⁵ Type desired stem length (4" -100") into product code above.	WLNx (Cooper Wavelinx, remote) ENLIGHT (Enlighted, remote) FCJS (Lutron, remote) FCJS/S (Lutron, remote, occ/daylight sensor) MLX (Molex POE, remote) NLT (nLight wired remote connection) NLTAIR (nLight AIR, remote connection, integral occ/daylight sensor) OS/PH/HV (Hubbel WASP remote occ/daylight sensor) ¹⁶ Default quantity is 1 sensor per fixture, type alternate quantity (/#) into product code above if desired and contact ALW to request price adjustment. Sensor descriptions available on page 9. ¹⁷ Not all sensors are compatible with all drivers. See 'Driver', 'Sensor' and lamping charts for driver details and sensor compatibility. Available for remote driver locations only.	EMB ¹⁵ Emergency Battery ¹⁵ Emergency options only available with 0-10V driver options. Third party inverter system recommended for other driver options. Refer to ALW EM Solution Catalog for all compatibility exceptions. ¹⁶ Available for Deep Canopy and Remote drivers only.

* See page 5 for finish chart.
* Manually type the finish code into the parametric code above.



DIMENSIONS AND MOUNTING

NOVA 3 PENDANT

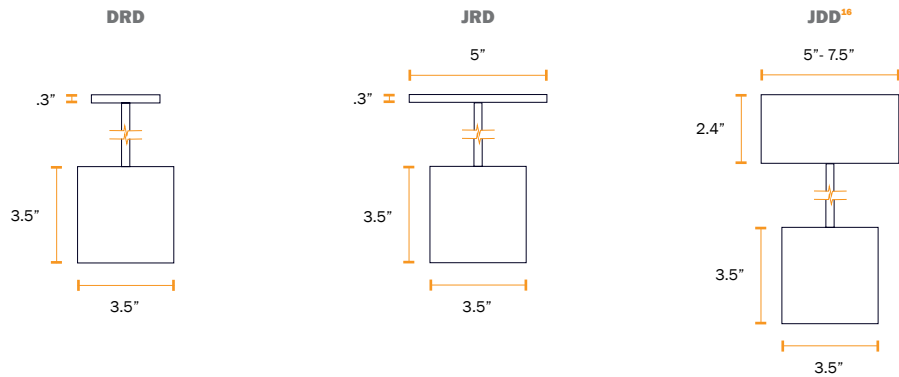

NOVA 3 SURFACE MOUNT

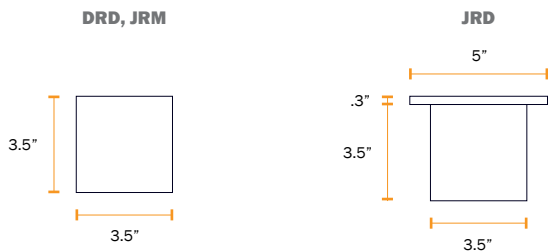

NOVA 3 SCONCE

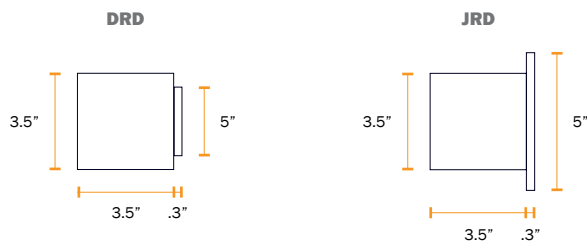

NOVA 3 YOKE

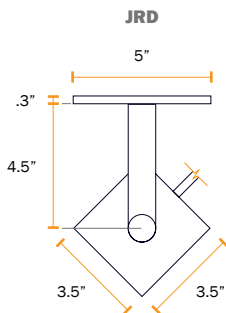

Not to scale. Dimensions are nominal. Consult factory for CAD drawings
JRD and JDD canopies fit standard 3.5" and 4" round and octagonal junction boxes.
¹⁶JDD Deep Canopy diameter depends on LED driver size.



DIMENSIONS AND MOUNTING

YOKE STANDARD CANOPY¹⁷

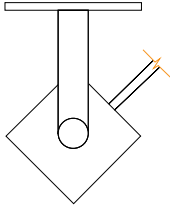

YOKE RIGID STEM¹⁷

includes 10° hang straight

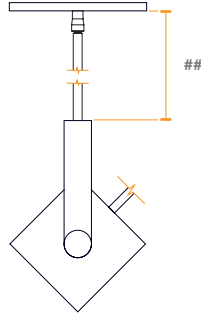

YOKE SWIVEL STEM¹⁷

360° rotation x 90° tilt swivel

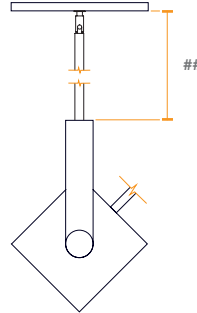

= length in inches from bottom of canopy to top of yoke

PENDANT SUSPENSION OPTIONS

SWIVEL STEM

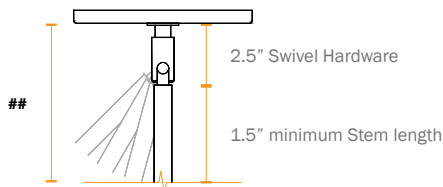

Order Code = **SS##**

= length in inches from bottom of canopy to top of fixture. Includes the swivel hardware. Minimum length for swivel hardware + stem is 4". Total length (##) for swivel hardware alone is 2.5".

360° rotation x 90° tilt swivel

RIGID STEM

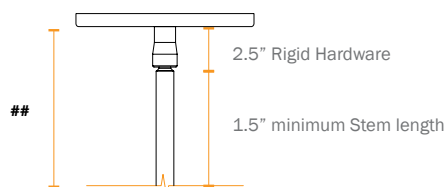

Order Code = **RS##**

= length in inches from bottom of canopy to top of fixture. Includes the rigid hardware. Minimum length for rigid hardware + stem is 4". Total length (##) for rigid hardware alone is 2.5".

Includes 10° hang straight

NOVA GLOW DIMENSIONS

NOVA GLOW RING/DISK PENDANT

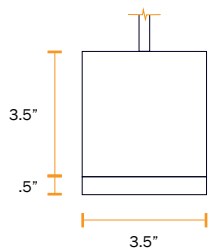

NOVA GLOW RING/DISK SURFACE MOUNT

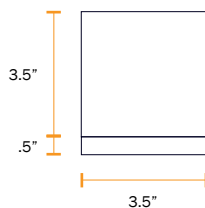

NOVA GLOW OPTICS

NOVA GLOW RING

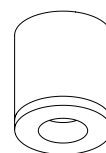

Order Codes

GN = Glow Narrow Beam
GM = Glow Medium Beam
GW = Glow Wide Beam

NOVA GLOW DISK

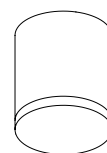

Order Code

GD = Glow Solid Diffuser

Not to scale. Dimensions are nominal consult factory for CAD drawings.

¹⁷Shown as JRD/DRD shallow canopy configuration. See page 3 for other configurations.

SS093024



FINISHES

Standard finishes are available at no additional charge and no extended lead time for standard configurations.

STANDARD FINISHES

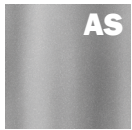

Aluminum Silver
Anodized Effect



Satin
White



Satin
Black



Textured
Black

PREMIUM FINISHES

BASIC POWDER COAT



Gloss
White

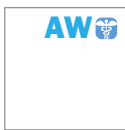

Antimicrobial
Gloss White

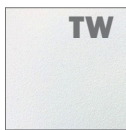

Textured
Matte
White

METALLIC POWDER COAT

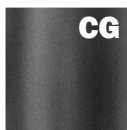

Charcoal
Gray

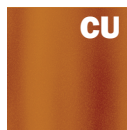

Copper



Brass

SATIN ANODIZED EFFECT POWDER COAT



Oil-Rubbed
Bronze



Dark
Bronze

GLOSS POWDER COAT (80-95% GLOSS)



Orange
RAL 2003



Red
RAL 3020



Magenta
RAL 4010



Blue
RAL 5015

Contact ALW Quotes for sample paint finish swatches.

SPECIAL ORDER FINISHES*



RAL CLASSIC COLORS (80-95% GLOSS): RAL_ _ _ _

Most RAL Classic Colors are available for a minimum setup fee. On your specification submittal choose your RAL color by entering the 4-digit RAL code (Ex: RAL 3003). See www.alw-inc.com/resources/finishes



CUSTOM COLOR MATCH: CCM_ _ _ _

Custom powder coat color matching is available for a premium setup fee. Consult ALW for additional information.

*An individual setup fee will apply to each unique Special Order Finish per purchase order.
(ex: RAL 5023 and RAL 2008 are specified for multiple line items on a purchase order. 2x setup fees will apply)

*Printed or on-screen colors are only approximations - consult actual Color Chip Set before specifying

CORD OPTIONS



Black
Order Code = **BK**

Standard cord for
Yoke suspensions.



White
Order Code = **WH**



Clear Silver Braid
Order Code = **CB**



Cloth Cover
Order Code = **CC**

For remote and deep canopy drivers only.

Specify cloth cord color in
the suspension section of the part
number. See page 6 for all cloth cord color
options.

SS093024



CLOTH CORD COLOR OPTIONS

FOR DAMP AND DRY LOCATIONS ONLY

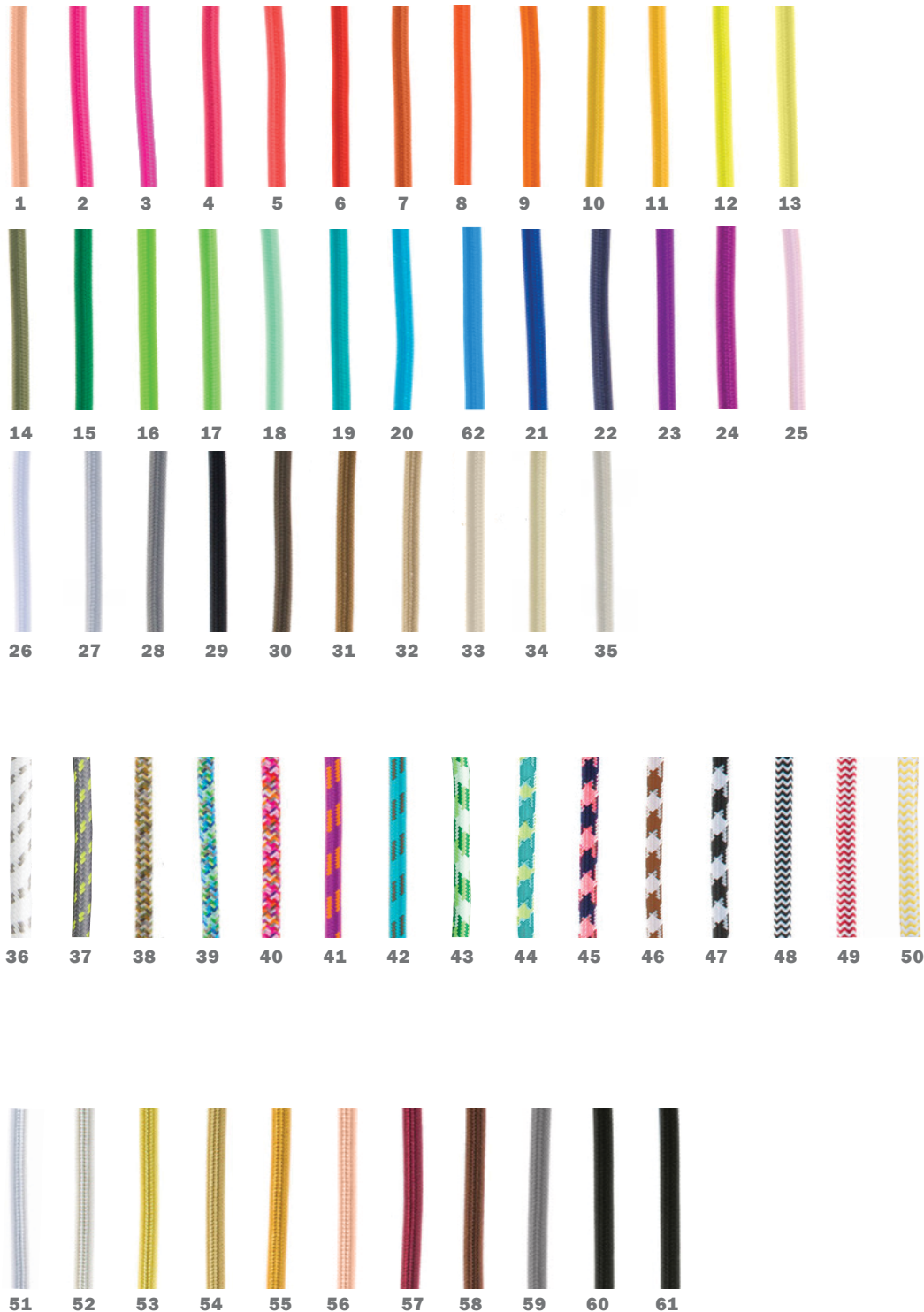

SPECIFY **CLOTH CORD COLOR** IN SUSPENSION OPTIONS IN PRODUCT CODE. PRINTED OR ON-SCREEN COLORS ARE ONLY APPROXIMATIONS - CONSULT SAMPLE BEFORE SPECIFYING

SOLID COLOR CLOTH CORDS

1. Peach
2. Pink
3. Neon Pink
4. Hot Pink
5. Neon Coral
6. Red
7. Adobe
8. Orange
9. Neon Orange
10. Goldenrod
11. Sunshine Yellow
12. Neon Yellow
13. Citrus Yellow
14. Olive Green
15. Kelly Green
16. Neon Green
17. Lime Green
18. Mint Green
19. Turquoise
20. Skyblue
21. Electric Blue
22. Cobalt Blue
23. Navy
24. Purple
25. Magenta
26. Blush
27. White
28. Silver
29. Gray
30. Black
31. Antique Brown
32. Chocolate Brown
33. Flax
34. Khaki
35. Sand
36. Ivory

PATTERNED CLOTH CORDS

36. White & Gray Dot
37. Gray & Citrus Yellow Dot
38. Neutral Tweed
39. Cool Tweed
40. Warm Tweed
41. Magenta & Orange Stripe
42. Turquoise & Brown Stripe
43. Green Argyle
44. Turq. & Yellow Houndstooth
45. Navy & Coral Houndstooth
46. Brown & Ivory Houndstooth
47. Black & White Houndstooth
48. Black & White Zigzag
49. Red & White Zigzag
50. Yellow & White Zigzag

METALLIC CLOTH CORDS

51. Pearl Metallic
52. Champagne Metallic
53. Yellow Gold Metallic
54. Brass Metallic
55. Copper Metallic
56. Copper Penny
57. Currant Metallic
58. Bronze Metallic
59. Gunmetal
60. Black Patent
61. Black Satin

SS093024



PERFORMANCE DETAILS

OPTICS OPTION	CRI	OUTPUT OPTION	DELIVERED LUMENS ¹⁸	EFFICACY (LM/W)	SYSTEM WATTS(W)	CCT OPTIONS
R1 - 10° R2 - 20° R4 - 40° L3 - 30° L6 - 60° L9 - 90° S1 - 50° x 15° S2 - 55° x 55° S3 - 85° x 85° GN GM GW GD¹⁹	Ra = 90 ± 3	500	467	126	3.7	2700K 3000K 3500K 4000K
		800	747	129	5.8	
		1000	934	128	7.3	
		1500	1401	124	11.3	
		2000	1868	118	15.8	

*Based on L6-60° lens for all outputs, 4000K 90CRI.

*Refer to IES files for full performance data.

¹⁸Actual lumens measured in field may differ +/- 10%.

¹⁹Glow Diffuse optics delivered lumens are up to 35% lower than the specified output.

TM-30-18 DETAILS (90 CRI LAMPING)

CCT	CRI (Ra)	CRI (R9)	TM-30 Rf	TM-30 Rg
2700K	90.5	59.7	89.4	99.6
3000K	92.5	66.5	89.9	98.7
3500K	93.8	74.2	89.8	98.1
4000K	94.2	78.8	89.8	98.5



DRIVERS

PRODUCT CODE	DESCRIPTION
V00	0-10V dimming down to 0%
V01	0-10V dimming down to 1%
P01	Driver supports both TRIAC Forward Phase 2-Wire and ELV Reverse Phase 3-Wire dimming controls.
ELDV0	eldoLED, 0-10V dimming down to 0%
DALI	DALI flicker-free dimming down to 0%.
DMX	DMX flicker-free dimming down to 0%.
LDE1	ECOSYS1, (LDE1) Lutron Hi-lume 1% EcoSystem LED driver with Soft-on, Fade-to-Black dimming technology
POEM	POE MOLEX. Molex CoreSync PoE LED Driver dimming down to 0.1%
POEI	IGOR PoE LED Driver. Contact ALW to assist with your project.
POEN	NuLEDS PoE LED Driver. Contact ALW to assist with your project.
POE	PoE Ready LED Driver. Contact ALW to assist with your project.

*Contact ALW for specific dimming level requests. ALW lighting fixtures are intended for use with a wide range of sensors, lighting controls, LED drivers, and building management systems. If there are specific components required for your application that aren't listed on this spec sheet, please contact ALW customer support today to specify a compatible solution of your choice.

DRIVER/LED LAMPING COMPATIBILITY			
	STANDARD LAMPING*	CA TITLE 24 JA8/JA10 ²⁰	IEEE P1789 & HD TV STUDIO ²¹
V00	●	●	
V01	●	●	
P01	●	●	
ELDV0	●	●	●
DALI	●	●	●
DMX	●	●	●
LDE1	●	●	●
POEM	PER REQUEST	●	●
POEI	PER REQUEST	●	●
POEN	PER REQUEST	●	●
POE	PER REQUEST	●	●

DRIVER LOCATION/DRIVER COMPATIBILITY			
	INTERNAL	DEEP CANOPY	REMOTE
V00		●	●
V01		●	●
P01		●	●
ELDV0		●	●
DALI		●	●
DMX		●	●
LDE1		●	●
POEM			●
POEI			●
POEN			●
POE			●

● - Indicates compatibility

*Standard lamping - 500-2000LM

²⁰Fixtures specified with 90CRI 2700K, 3000K, 3500K, and 4000K lamping with applicable LED drivers have the ability to conform to California Title 24 JA8 and JA10 Appendices.

²¹The following drivers conform to IEEE P1789 Flicker Standard: 'IEEE Recommended Practices for Modulating Current in High-Brightness LEDs for Mitigating Health Risks to Viewers'. These drivers may also be installed in HD TV Studio applications utilizing high frequency camera equipment.

SS093024



SENSORS*

	PRODUCT CODE	DESCRIPTION	DRIVER LOCATION	SENSOR LOCATION
	N	None. Choose when sensors are not desired.	-	-
COOPER	WLNx	Fixture is built with 0/10V wiring to connect to Wavelinx Wireless sensors and power/relay packs (sensors and equipment not provided by ALW)	Deep Canopy Remote	Remote
ENLIGHTED™	ENLGHt	Enlighted® remote connected lighting smart sensor - occ/daylight/networking (Enlighted Part: SU-5S-H-CL)	Remote	
LUTRON VIVE	FCJS	Lutron® Vive remote RF wireless fixture control (Lutron Part: FCJS-ECO or FCJS-010)	Remote	
	FCJS/S	Lutron® Vive remote RF wireless fixture control + daylight/occ sensor (Lutron Part: FCJS-ECO or FCJS-010, & FC-Sensor)	Remote	
MOLEX POE CORESYNC	MLX	Molex PoE sensors for use with Molex/PoE drivers. Customer will need to determine who to purchase PoE equipment from.	Remote	
NLIGHT WIRED®	NLT	Fixture is built to connect to nLight Wired remote components specified by agency. Contact ALW to review project details.	Remote	
NLIGHT WIRELESS®	NLTAIR	Fixture is built to connect to nLight Air (Wireless) remote components specified by agency. Contact ALW to review project details.	Remote	
VALUE SENSORS	OS/PH/HV	Hubbell WASP High Voltage 0-10V remote surface mount occ/daylight sensor. 120/277/347VAC input (Hubbell Part: WSPDSMUNV) Automated Dimming Functionality: Connect fixture 0/10V wires to sensor in the field. Adjust occ/photocell settings as desired. On/Off or Manual Dimming Functionality: Turn photocell functionality OFF. Cap off 0/10V wires on sensor. Connect fixture 0/10V wires to wall dimmer in the field.	Deep Canopy Remote	

*All connected lighting sensors/systems must be programmed in the field by an electrical commissioner familiar with the system. Refer to the 'Sensor Compatibility' and 'Driver/Sensor Compatibility' charts to specify compatible sensors, LED lamping, and LED driver systems.

SENSOR COMPATIBILITY					
PRODUCT CODE		SENSOR TYPE	MAX MT HT	CA TITLE 24	STD*
COOPER WAVELINX	WLNx		15 ft	●	●
ENLIGHTED™	ENLGHt	OCCUPANCY/PHOTOCELL	40 ft	●	●
LUTRON VIVE	FCJS	WIRELESS CONTROL	12 ft	●	●
	FCJS/S	OCCUPANCY/PHOTOCELL	12 ft	●	●
MOLEX POE CORESYNC	MLX		16 ft	●	●
NLIGHT WIRED	NLT		15 ft	●	●
NLIGHT WIRELESS	NLTAIR		15 ft (average)	●	●
VALUE SENSORS	OS/PH/HV	OCCUPANCY/PHOTOCELL	45 ft	●	●

● - Indicates compatibility ■ - On/off sensor functionality only

*Standard lamping (STD) - 500 - 2000LM

DRIVER/SENSOR COMPATIBILITY									
	WLNx	ENLGHt	MLX	FCJS	FCJS/S	NLT	NLTAIR	OS/PH/HV	NO SENSOR
V00	●	●		●	●			■	●
V01	●	●		●	●			■	●
P01								■	●
ELDV0						●	●	▲	●
DALI								■	●
DMX								■	●
LDE1				●	●				●
POEM			●						●
POEI	Sensor types will depend on the PoE system configuration. Contact ALW for details.								
POEN	Sensor types will depend on the PoE system configuration. Contact ALW for details.								
POE	Sensor types will depend on the PoE system configuration. Contact ALW for details.								

● - Indicates compatibility

▲ - Fixture can have automated dimming via sensor OR on/off functionality and manual dimming

■ - On/off sensor functionality only

SS093024



PHOTOMETRICS NOVA

BEAM ANGLE (°)	POLAR PLOT (CD)	MTG HEIGHT (FT)	LIGHT LEVEL (FC)	BEAM DIAMETER (FT)	SPACING CRITERION (SC) ²² (0°- 180°) (90°- 270°)	MAX INTENSITY (CD)
R1 10°		6.0	439.8	1.0	0.17 0.17	15831
		8.0	247.4	1.3		
		10.0	158.3	1.7		
		12.0	109.9	2.0		
		14.0	80.8	2.4		
		16.0	61.8	2.7		
R2 20°		6.0	124.4	2.3	0.37 0.37	4478
		8.0	70.0	3.1		
		10.0	44.8	3.8		
		12.0	31.1	4.6		
		14.0	22.8	5.4		
		16.0	17.5	6.1		
R4 40°		6.0	61.3	4.3	0.63 0.63	2206
		8.0	34.5	5.7		
		10.0	22.1	7.2		
		12.0	15.3	8.6		
		14.0	11.3	10.1		
		16.0	8.6	11.5		
L3 30°		6.0	106.4	3.2	0.5 0.5	3831
		8.0	59.9	4.2		
		10.0	38.3	5.3		
		12.0	26.6	6.3		
		14.0	19.5	7.4		
		16.0	15.0	8.4		
L6 60°		6.0	35.7	6.7	1.0 1.0	1466
		8.0	20.1	8.9		
		10.0	12.8	11.1		
		12.0	8.9	13.3		
		14.0	6.6	15.6		
		16.0	5.0	17.8		
L9 90°		6.0	13.5	11.1	1.58 1.58	705
		8.0	7.6	14.8		
		10.0	4.9	18.5		
		12.0	3.4	22.2		
		14.0	2.5	26.0		
		16.0	1.9	29.7		

CONTINUES ON NEXT PAGE →

SS093024



PHOTOMETRICS NOVA

BEAM ANGLE (°)	POLAR PLOT (CD)	MTG HEIGHT (FT)	LIGHT LEVEL (FC)	BEAM DIAMETER (FT)	SPACING CRITERION (SC) ²² (0°- 180°) (90°- 270°)	MAX INTENSITY (CD)
S1 50° x 15°		6.0	98.8	3.7	0.82 0.3	3618
		8.0	55.6	5.0		
		10.0	35.6	6.2		
		12.0	24.7	7.5		
		14.0	18.2	8.7		
		16.0	13.9	10.0		
S2 55° x 55°		6.0	34.4	6.3	0.92 0.92	1317
		8.0	19.3	8.4		
		10.0	12.4	10.5		
		12.0	8.6	12.6		
		14.0	6.3	14.7		
		16.0	4.8	16.8		
S3 85° x 85°		6.0	15.5	9.5	1.45 1.45	879
		8.0	8.7	12.6		
		10.0	5.6	15.8		
		12.0	3.9	18.9		
		14.0	2.8	22.1		
		16.0	2.2	25.2		
WALL WASH		6.0	15.1	5.1	1.77 1.13	1236
		8.0	8.5	6.8		
		10.0	5.4	8.5		
		12.0	3.8	10.2		
		14.0	2.8	11.9		
		16.0	2.1	13.6		
DOUBLE WALL WASH		6.0	5.5	7.1	0.88 2.7	1176
		8.0	3.1	9.4		
		10.0	2.0	11.8		
		12.0	1.4	14.1		
		14.0	1.0	16.5		
		16.0	0.8	18.8		

CONTINUES ON NEXT PAGE →

SS093024



PHOTOMETRICS NOVA GLOW

BEAM ANGLE (°)	POLAR PLOT (CD)	MTG HEIGHT (FT)	LIGHT LEVEL (FC)	BEAM DIAMETER (FT)	SPACING CRITERION (SC) ²² (0°- 180°) (90°- 270°)	MAX INTENSITY (CD)
GN		6.0	247.8	1.3	0.21 0.21	8922
		8.0	139.4	1.7		
		10.0	89.2	2.2		
		12.0	62.0	2.6		
		14.0	45.5	3.1		
		16.0	34.9	3.5		
GM		6.0	89.3	2.2	0.34 0.34	3216
		8.0	50.3	2.9		
		10.0	32.2	3.7		
		12.0	22.3	4.4		
		14.0	16.4	5.2		
		16.0	12.6	5.9		
GW		6.0	56.3	3.9	0.53 0.53	2025
		8.0	31.6	5.2		
		10.0	20.3	6.5		
		12.0	14.1	7.8		
		14.0	10.3	9.1		
		16.0	7.9	10.4		
GD		6.0	10.6	13.2	1.14 1.14	381
		8.0	6.0	17.6		
		10.0	3.8	22.0		
		12.0	2.6	26.4		
		14.0	1.9	30.9		
		16.0	1.5	35.3		

*NOVA Photometric calculations based on 1500lm 4000K 90CRI fixture combination. Actual results may vary in the field.

*NOVA GLOW Photometric calculations based on NOVA 2 GLOW at 1500lm 4000K 90CRI fixture combination. Actual results may vary in the field.

*For footcandle and output multipliers refer to the [ALW IES File Multipliers Chart](#).

²²Spacing criterion refers to maximum distance luminaires can be spaced to provide uniform illumination on the working plane or surface.

Luminaire spacing = Spacing Criterion (SC) x Mounting Height (MH) (ex. 1.14 (SC) x 10' (MH) = 11.4' Luminaire Spacing).

SS093024



ADDITIONAL OPTIONS & SPECIFICATIONS

LED PERFORMANCE

> 55,000 hours at 80% lumen maintenance, LM80 / TM-21

COLOR CONSISTENCY

3 SDCM; 90 CRI typical

HOUSING

Extruded aluminum with galvanized steel hardware

SAFETY & REGULATORY

Can be used to comply with **Title 24 JA8 and JA10** requirements. Contact ALW customer support today and we can help you with your project requirements.

UL Listed (U.S. & Canada). Suitable for dry or damp locations.
Conforms to UL 2108, 8750
Certified to CSA std. CSA C22.2# 9 & #250.0

OPERATING TEMPERATURE

Luminaire should be installed and operated **ONLY** in dry or damp environments where the ambient temperature ranges from -4 °F to 104 °F (-20 °C to 40 °C). Luminaire operation in environments outside the listed temperature range voids the warranty AND may damage the product or adversely impact lamp life, lumen output and color consistency.

CONTROLS, SENSORS, & LED DRIVER

ALW lighting fixtures are intended for use with a wide range of sensors, lighting controls, LED drivers, and building management systems. Our component portfolio is continually expanding to adopt to the latest technologies and specification needs. We currently support integration with Lutron, Enlighted, EldoLED, nLight, Osram, Philips, and more. If there's a component or system needed that you don't see on the spec sheet please contact ALW customer support today so we can review your requirements.

WARRANTY

LIMITED WARRANTY. Visit alw-inc.com for more information.

WEIGHT

NOVA 3			
PENDANT	SURFACE MOUNT	SCONCE	YOKE
1.2 lbs/ 0.6 kg	1.2 lbs/ 0.6 kg	1.2 lbs/ 0.6 kg	1.2 lbs/ 0.6 kg

NOVA 3 GLOW	
PENDANT	SURFACE MOUNT
1.5 lbs/ 0.7 kg	1.5 lbs/ 0.7 kg